

VARIATION AA

JEDEC SOLID STATE
PRODUCT OUTLINE
Copyright © 2024 JEDEC

THIS *REGISTERED OUTLINE* HAS BEEN PREPARED BY THE JEDEC JC-11 COMMITTEE AND REFLECTS A PRODUCT WITH ANTICIPATED USAGE IN THE ELECTRONICS INDUSTRY; CHANGES ARE LIKELY TO OCCUR.

TITLE PLASTIC DUAL SMALL
OUTLINE, GULL WING, 2.00 MM
PITCH, RECTANGULAR PACKAGE

PACKAGE DESIGNATOR
H-PDSO-G12_I2p0-
12p0x9p4Z2p8

ITEM
MO-359

ISSUE
B

DATE
JUL 2024

SHEET
1 OF 7

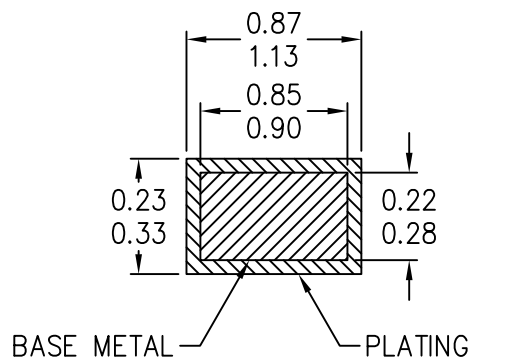
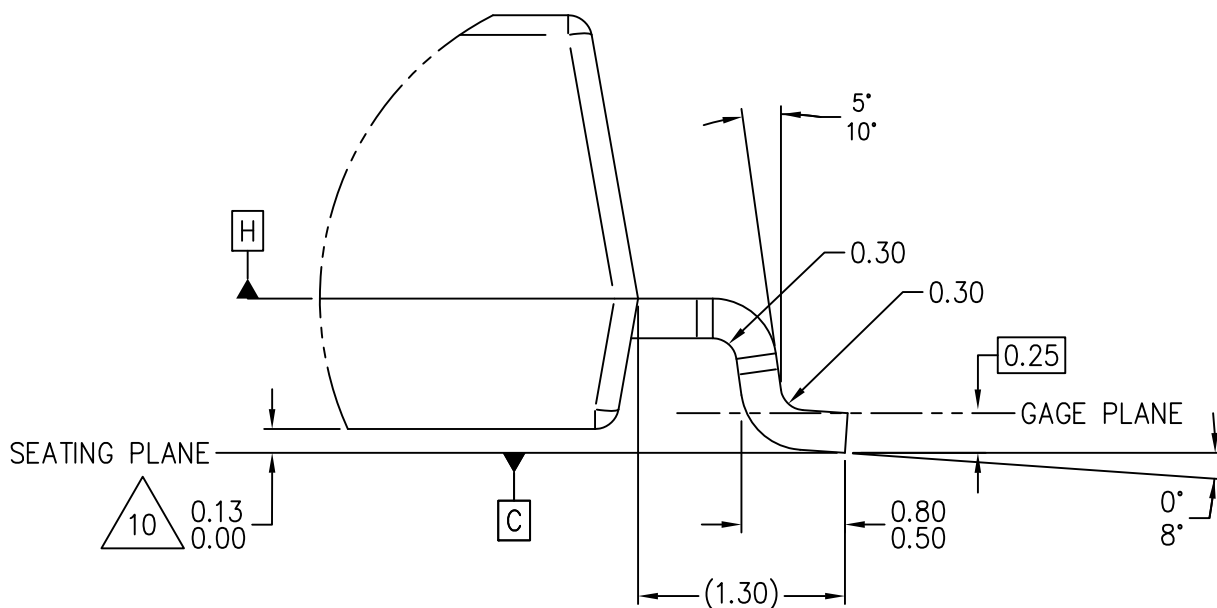
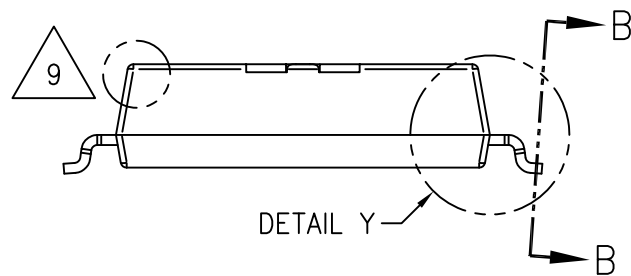

SECTION B-B

VARIATION AA

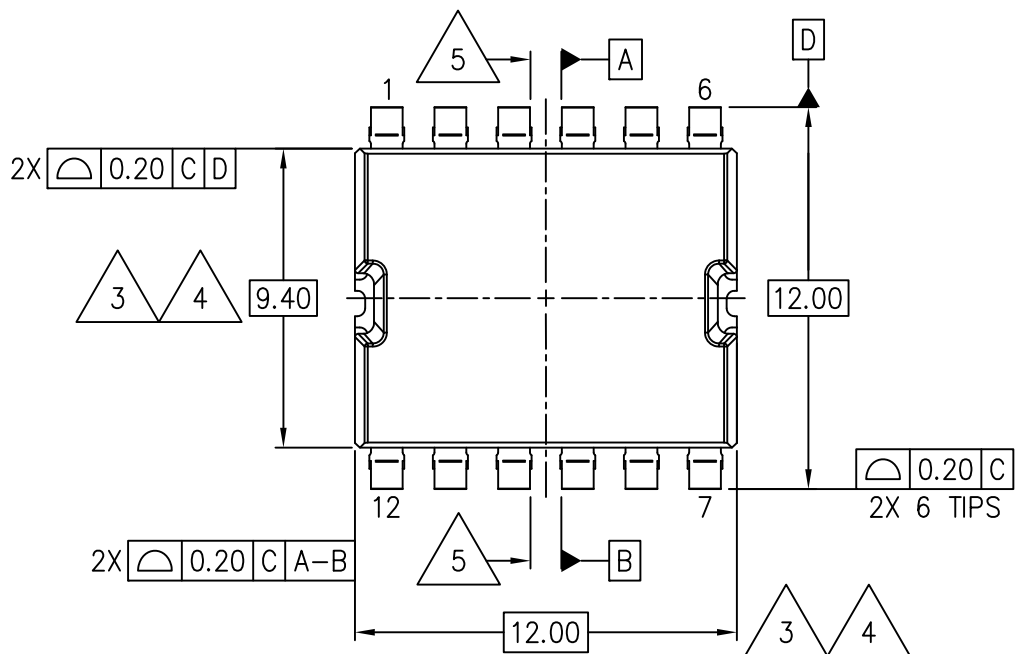
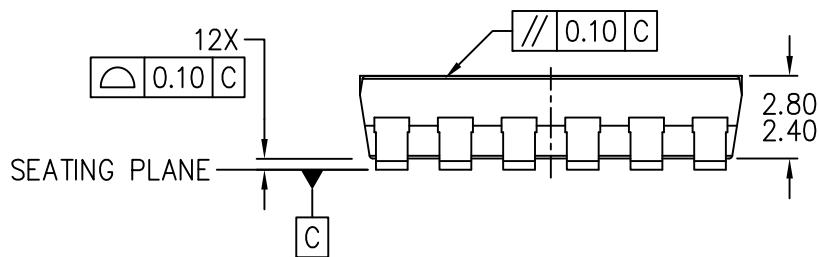
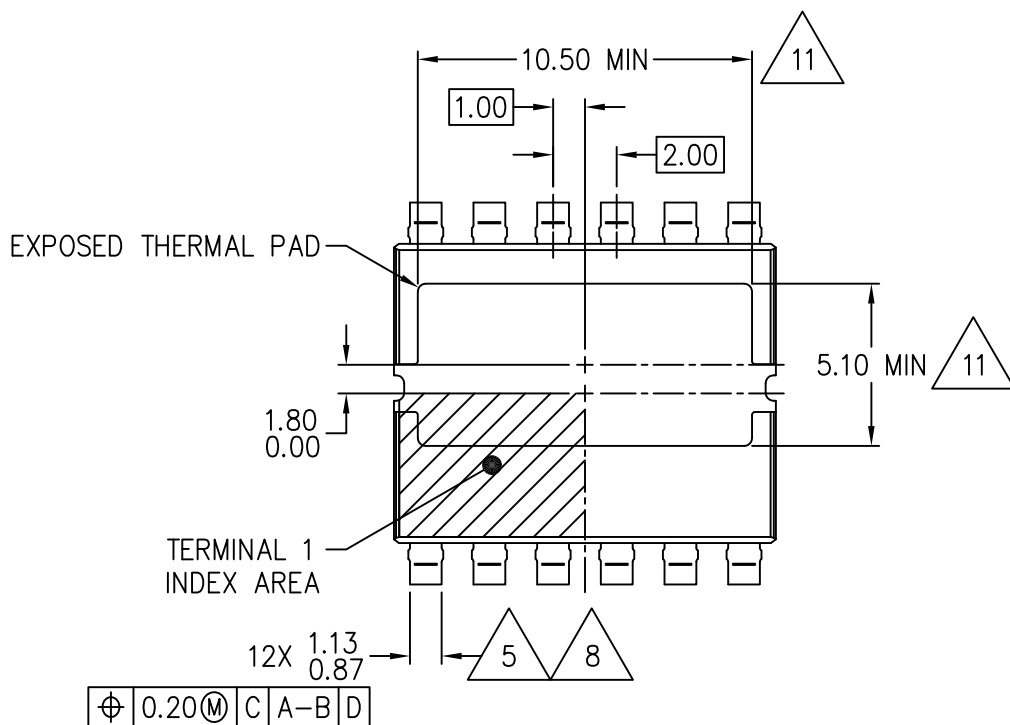

VARIATION AB

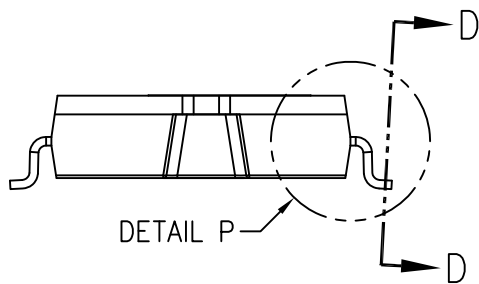

VIEW C-C

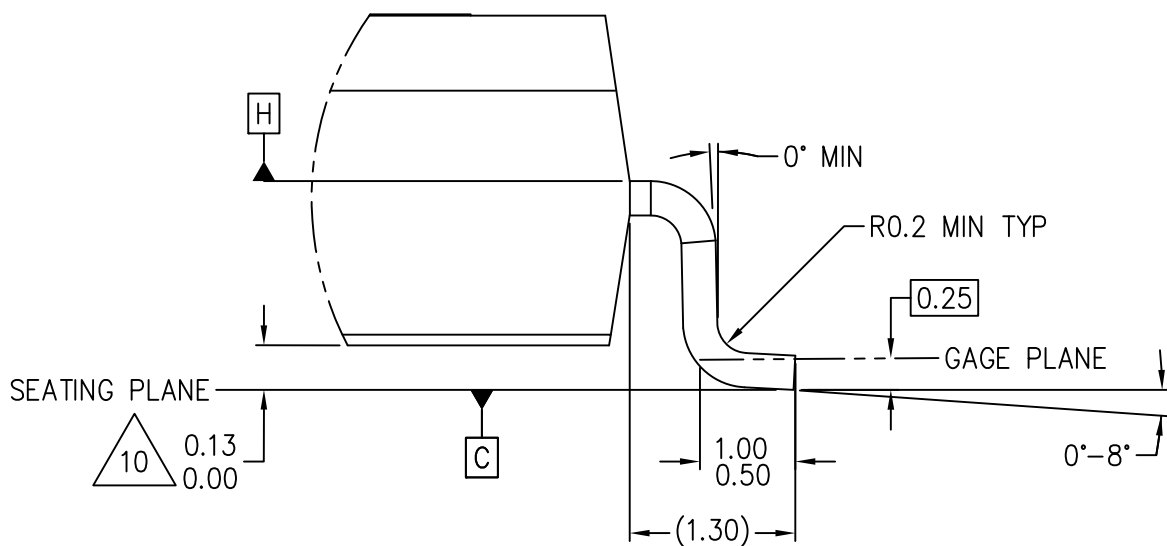

DETAIL P

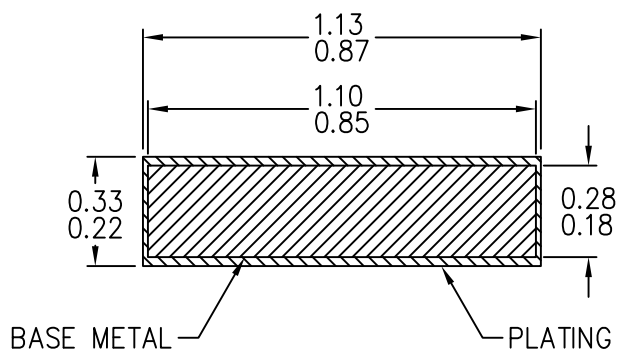

SECTION D-D 

VARIATION AB

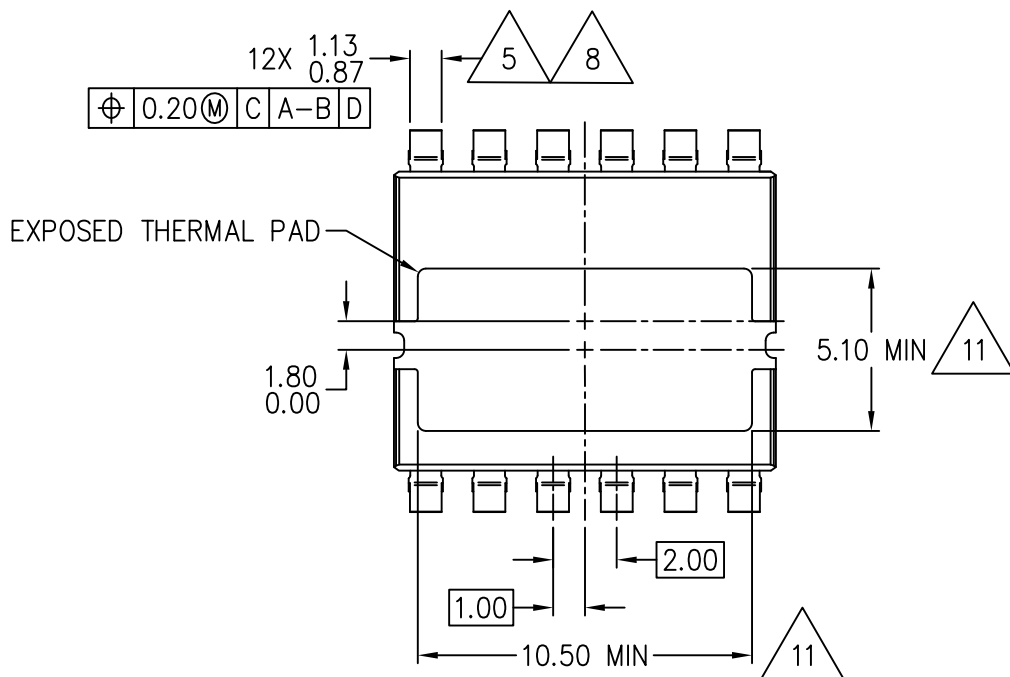
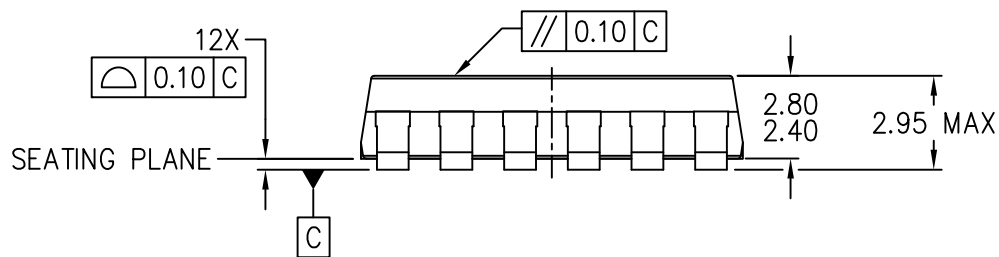
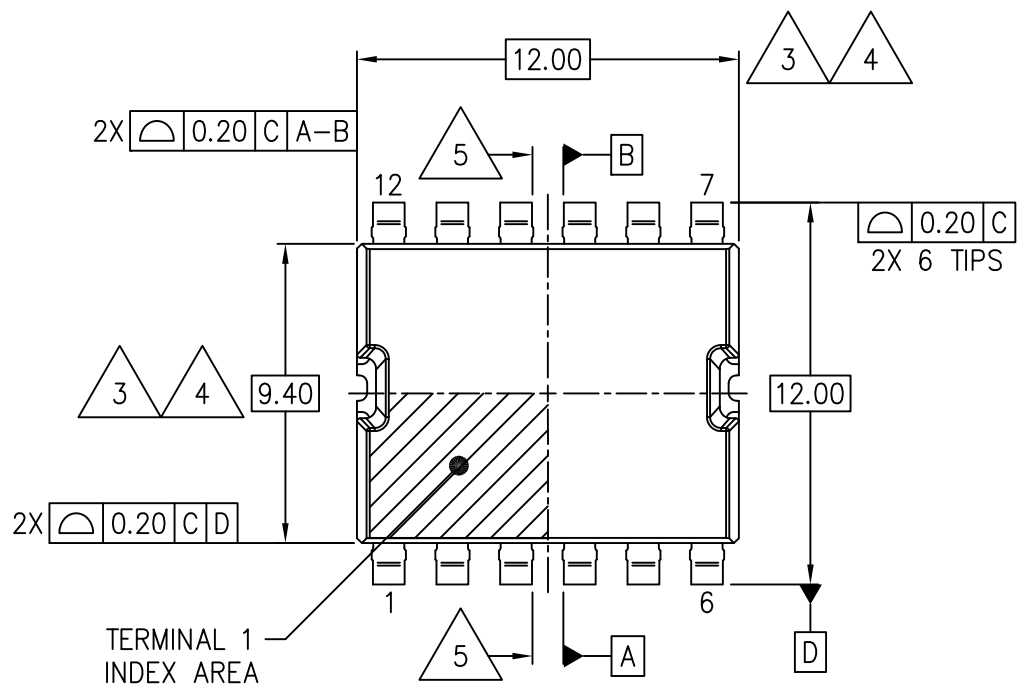

VARIATION BA

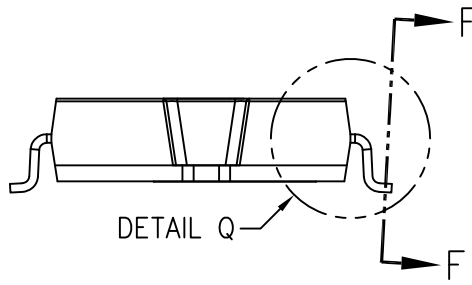

VIEW E-E

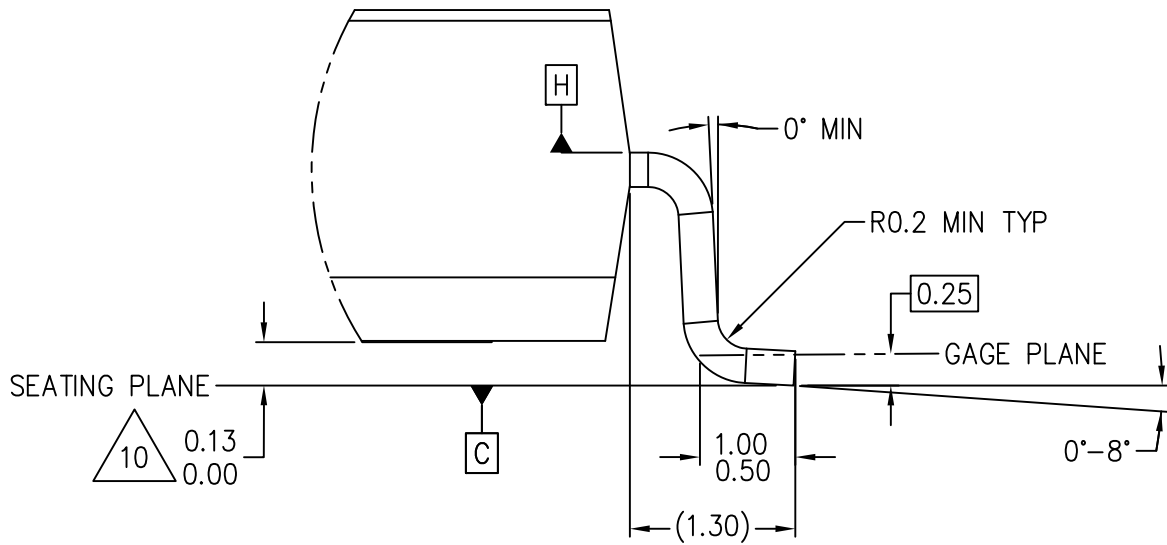

DETAIL Q

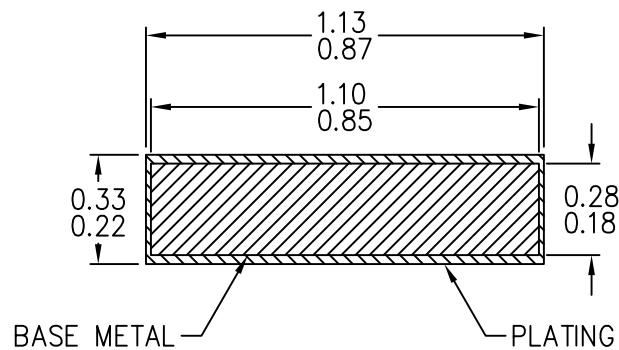

SECTION F-F 

VARIATION BA

NOTES:

1. DIMENSIONING AND TOLERANCING PER ASME Y14.5–2009.

2. ALL DIMENSIONS ARE IN MILLIMETERS (ANGLES IN DEGREES).

3 THE 12.00 DIMENSION (BODY X) DOES NOT INCLUDE MOLD FLASH, PROTRUSIONS OR GATE BURRS. MOLD FLASH, PROTRUSIONS OR GATE BURRS SHALL NOT EXCEED 0.15 MM PER END. THE 9.40 DIMENSION (BODY Y) DOES NOT INCLUDE INTERLEAD FLASH OR PROTRUSION. INTERLEAD FLASH OR PROTRUSION SHALL NOT EXCEED 0.25 MM PER SIDE. THE BODY X AND BODY Y DIMENSIONS ARE DETERMINED AT DATUM H.

4 THE PACKAGE TOP MAY BE SMALLER THAN THE PACKAGE BOTTOM. THE 12.00 (BODY X) AND 9.40 (BODY Y) DIMENSIONS ARE DETERMINED AT THE OUTERMOST EXTREMES OF THE PLASTIC BODY EXCLUSIVE OF MOLD FLASH, TIE BAR BURRS, GATE BURRS, AND INTERLEAD FLASH, BUT INCLUDING ANY MISMATCH BETWEEN THE TOP AND BOTTOM OF THE PLASTIC BODY.

5 DATUMS A & B TO BE DETERMINED AT DATUM H.

6. 'N' IS THE MAXIMUM NUMBER OF TERMINAL POSITIONS FOR THE SPECIFIED PACKAGE LENGTH.

7 THE DIMENSIONS APPLY TO THE FLAT SECTION OF THE LEAD BETWEEN 0.10 MM TO 0.25 MM FROM THE LEAD TIP.

8 TERMINAL WIDTH DOES NOT INCLUDE DAMBAR PROTRUSION. ALLOWABLE DAMBAR PROTRUSION SHALL BE 0.10 MM TOTAL IN EXCESS OF THE TERMINAL WIDTH MAXIMUM MATERIAL CONDITION. THE DAMBAR MAY NOT BE LOCATED ON THE LOWER RADIUS OF THE FOOT.

9 THIS CHAMFER FEATURE IS OPTIONAL. IF IT IS NOT PRESENT, THEN A TERMINAL 1 IDENTIFIER MUST BE LOCATED WITHIN THE INDEX AREA INDICATED.

10 THE 0.13/0.00 DIMENSION IS DEFINED AS THE VERTICAL DISTANCE FROM THE SEATING PLANE TO THE LOWEST POINT ON THE PACKAGE BODY EXCLUDING THE LID AND OR THERMAL ENHANCEMENT ON CAVITY DOWN PACKAGE CONFIGURATIONS.

11 THERMAL PAD X AND THERMAL PAD Y DIMENSIONS OF THERMALLY ENHANCED TYPES ARE VARIABLES DEPENDING ON DEVICE FUNCTION (DIE PADDLE SIZE). THERMAL PAD X AND THERMAL PAD Y MAXIMUM DIMENSIONS CAN BE EQUAL TO BODY X AND BODY Y MAXIMUM DIMENSIONS. END USER SHOULD VERIFY ACTUAL SIZE OF EXPOSED THERMAL PAD FOR SPECIFIC DEVICE APPLICATION.

STP (3D) FILE RECORD

3D FILE NAMES MAY EXCEED LENGTH REQUIREMENTS FOR SOME SOFTWARE TOOLS.

| STP FILE NAME | DATE | ITEM NUMBER |
|---|----------|----------------|
| MO-359A-AA_H-PDSO-G12_I2p0-12p0x9p4Z2p8 | SEP 2023 | 11-1034 |
| MO-359B-AB_H-PDSO-G12_I2p0-12p0x9p4Z2p8 | JUL 2024 | 11-1049 |
| MO-359B-BA_H-PDSO-G12_I2p0-12p0x9p4Z2p8 | JUL 2024 | 11-1049 |
| | | |
| | | |

TASK GROUP CONTRIBUTORS

NEXPERIA GERMANY GmbH
STMicroelectronics

| | | | | | |
|--|---|----------------|------------|------------------|-------------|
| JEDEC SOLID STATE PRODUCT OUTLINE Copyright © 2024 JEDEC | TITLE PLASTIC DUAL SMALL OUTLINE, GULL WING, 2.00 MM PITCH, RECTANGULAR PACKAGE | ITEM MO-359 | ISSUE B | DATE JUL 2024 | SHEET ii |
|--|---|----------------|------------|------------------|-------------|

CHANGE RECORD

IF THE CHANGE INVOLVES ANY WORDS ADDED OR DELETED (EXCLUDING DELETION OF ACCIDENTALLY REPEATED WORDS), THE CHANGE IS TO BE INCLUDED BELOW. PUNCTUATION CHANGES MAY OR MAY NOT BE INCLUDED.

| | | |
|------------------|----------------------|----------------------|
| INITIAL ISSUE: A | DATE: SEPTEMBER 2023 | ITEM NUMBER: 11-1034 |
|------------------|----------------------|----------------------|

| |
|------------------------|
| CHANGE RECORD HISTORY: |
|------------------------|

| | | |
|----------|----------------|----------------------|
| ISSUE: B | DATE: JUL 2024 | ITEM NUMBER: 11-1049 |
|----------|----------------|----------------------|

| | | |
|--------------|---------------|-------------------------|
| LOCATION: | CHANGED FROM: | CHANGED TO: |
| SHEETS 1 & 2 | | ADDED NAME VARIATION AA |
| SHEETS 3-6 | | VARIATION AB/BA |